

Chameleon Harmonica Workwall



Mounting guide



SMIT VISUAL
we make it visible

Important

Tools

- Glass lifters
- Rubber hammer
- Screw driver

Delivery: coordinate the delivery with us. Please note that we use pallets for delivery. Preferably we deliver the goods to our partners and the mounting team will bring them on site.

For the assembly, please keep in mind the following:

- Assembly to be done by at least 2 persons
- We suggest using glass lifters for handling the whiteboard panels
- Put the wheels on the brakes
- The whiteboard panels can be slightly repositioned after assembly. Use the rubber hammer and the glass lifter to strike (strike the glass lifter which is sucked onto the whiteboard) it into place.

First cleaning:

We recommend cleaning the whiteboard surfaces with whiteboard or glass cleaner before first use, to remove any dirt left by the production process and to ensure a perfect dry erasability.

Contents:

- Frame with pre-mounted magnetic mounting plates and strips
- Whiteboard and/or PET-felt panels
- 4 feet with wheels
- 16 countersunk allen bolts M8x16
- 8 countersunk screws 4,5x20

1

Assembly feet

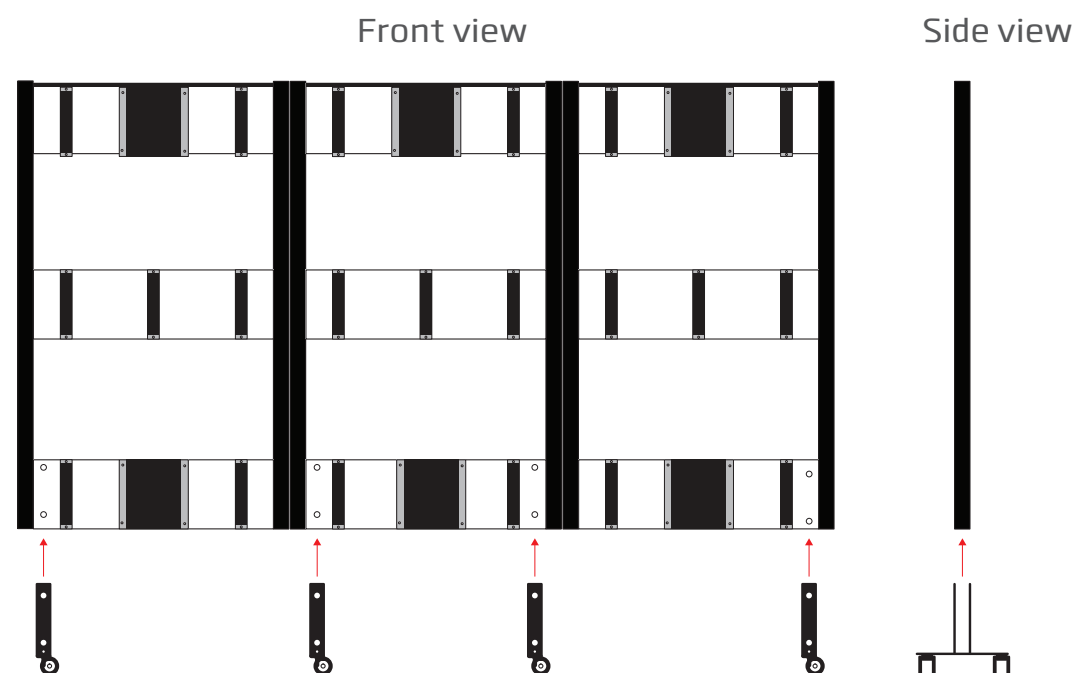

3

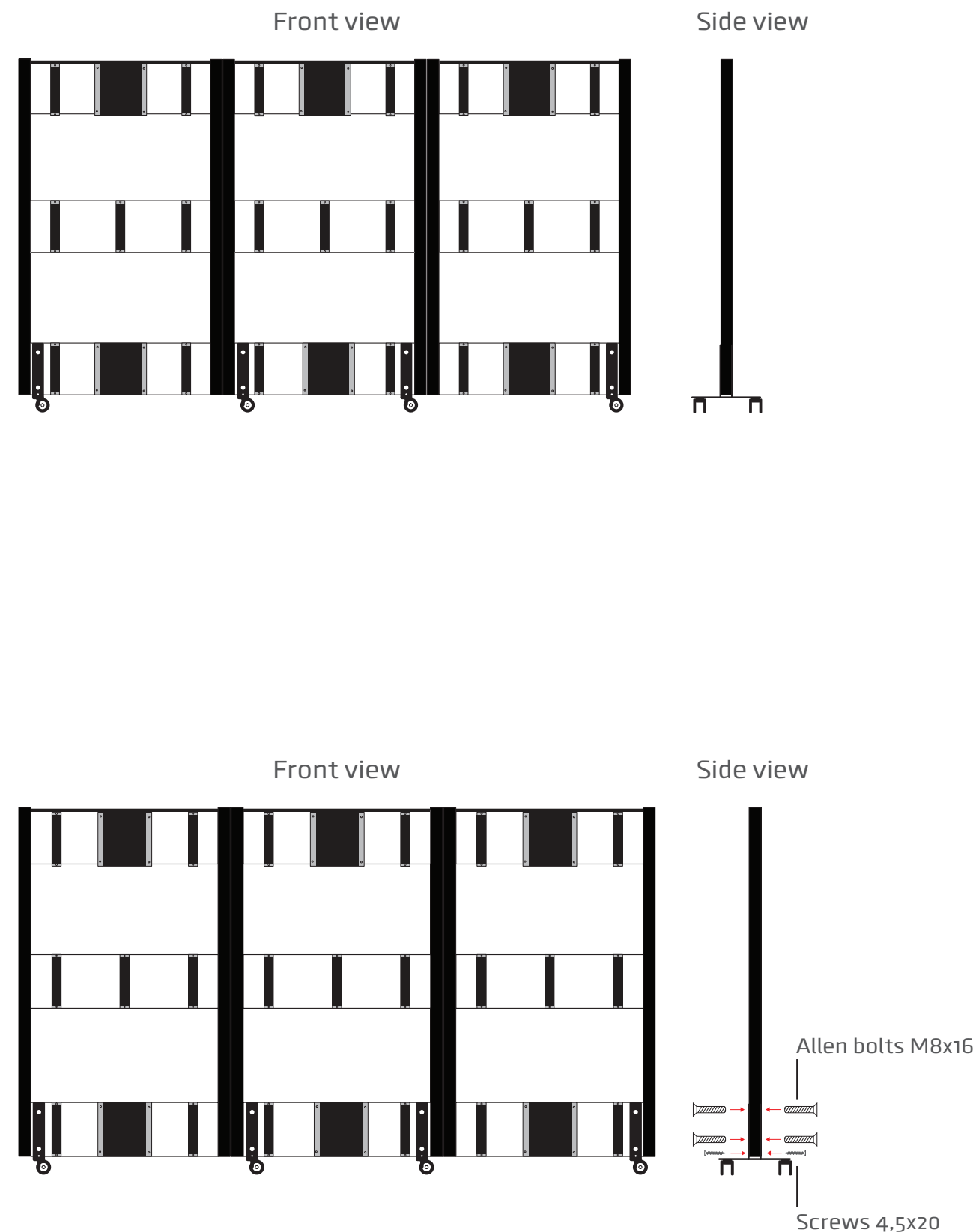

Assembly panels

1

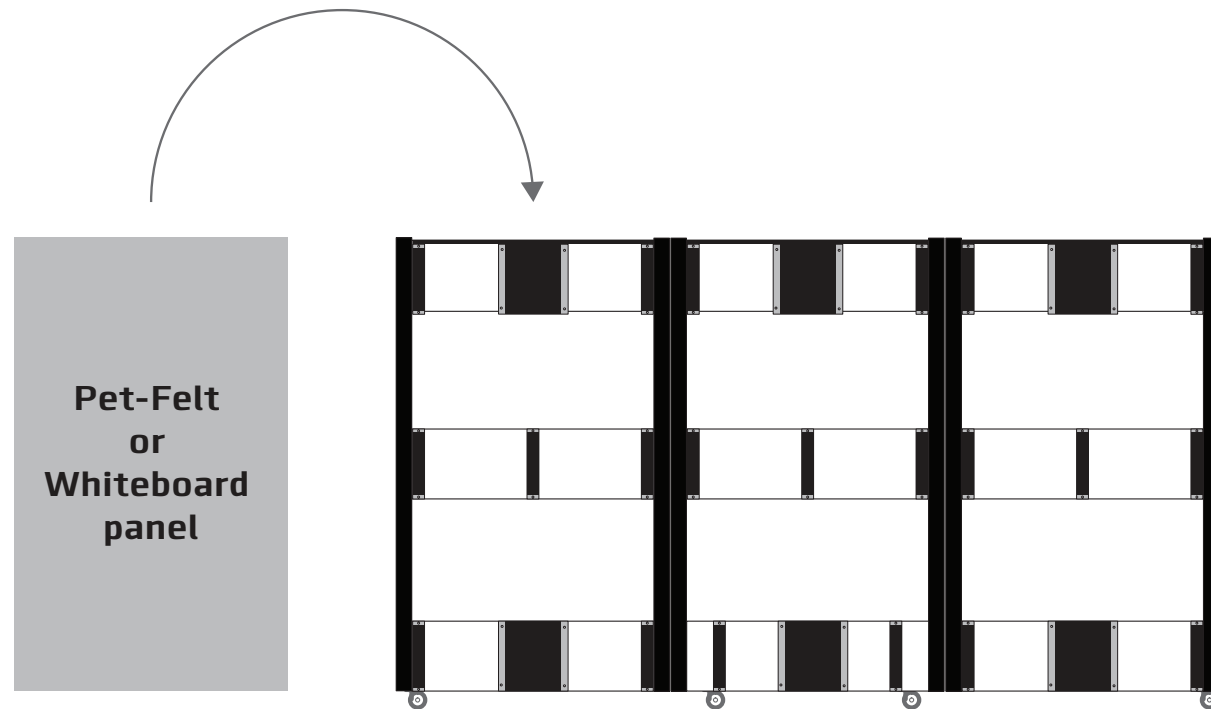

To prevent damage or scratches during assembly, please cover the base of the stand.

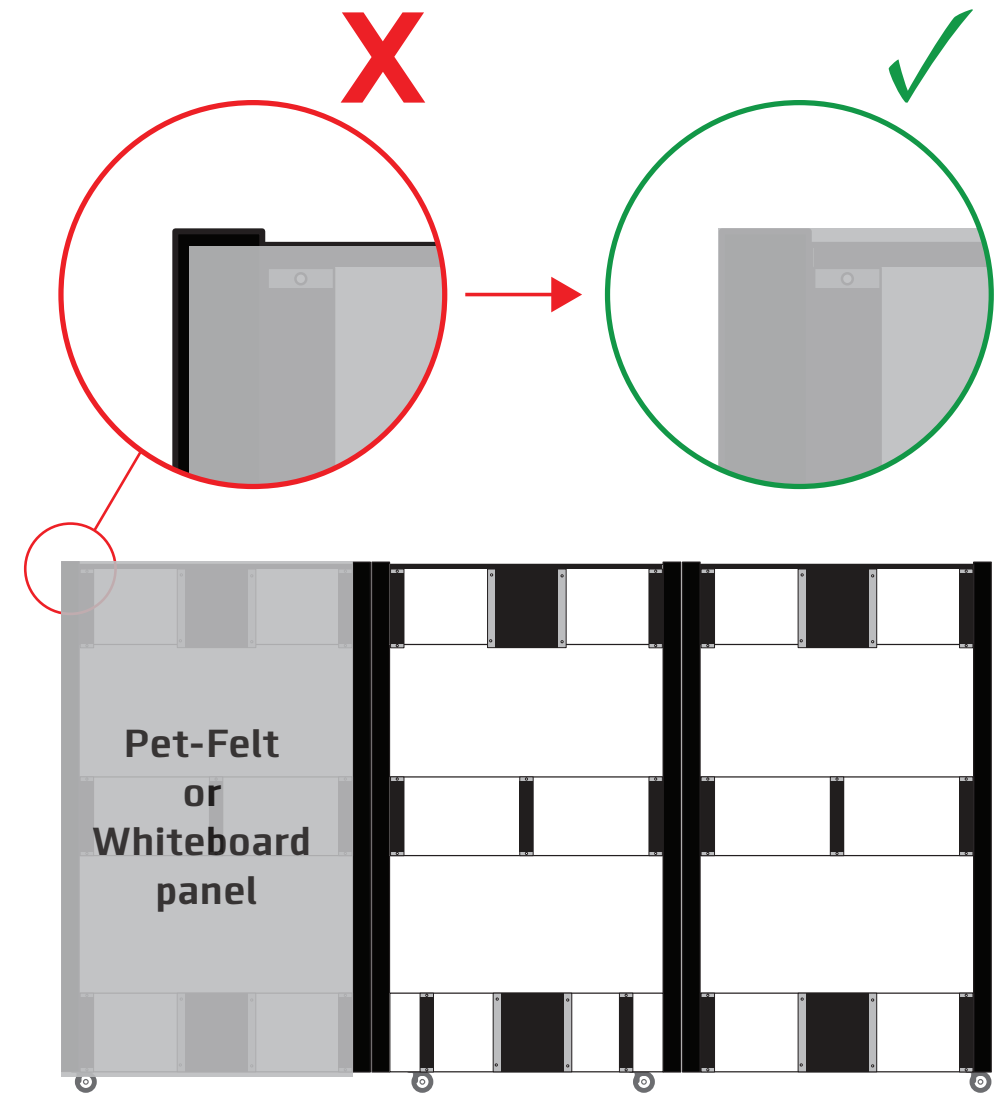
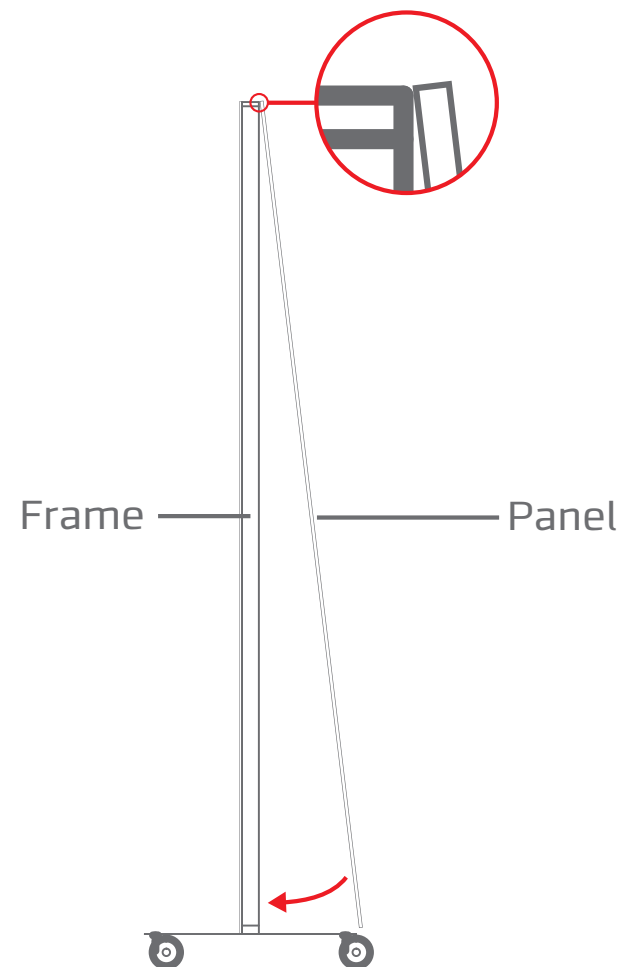

2

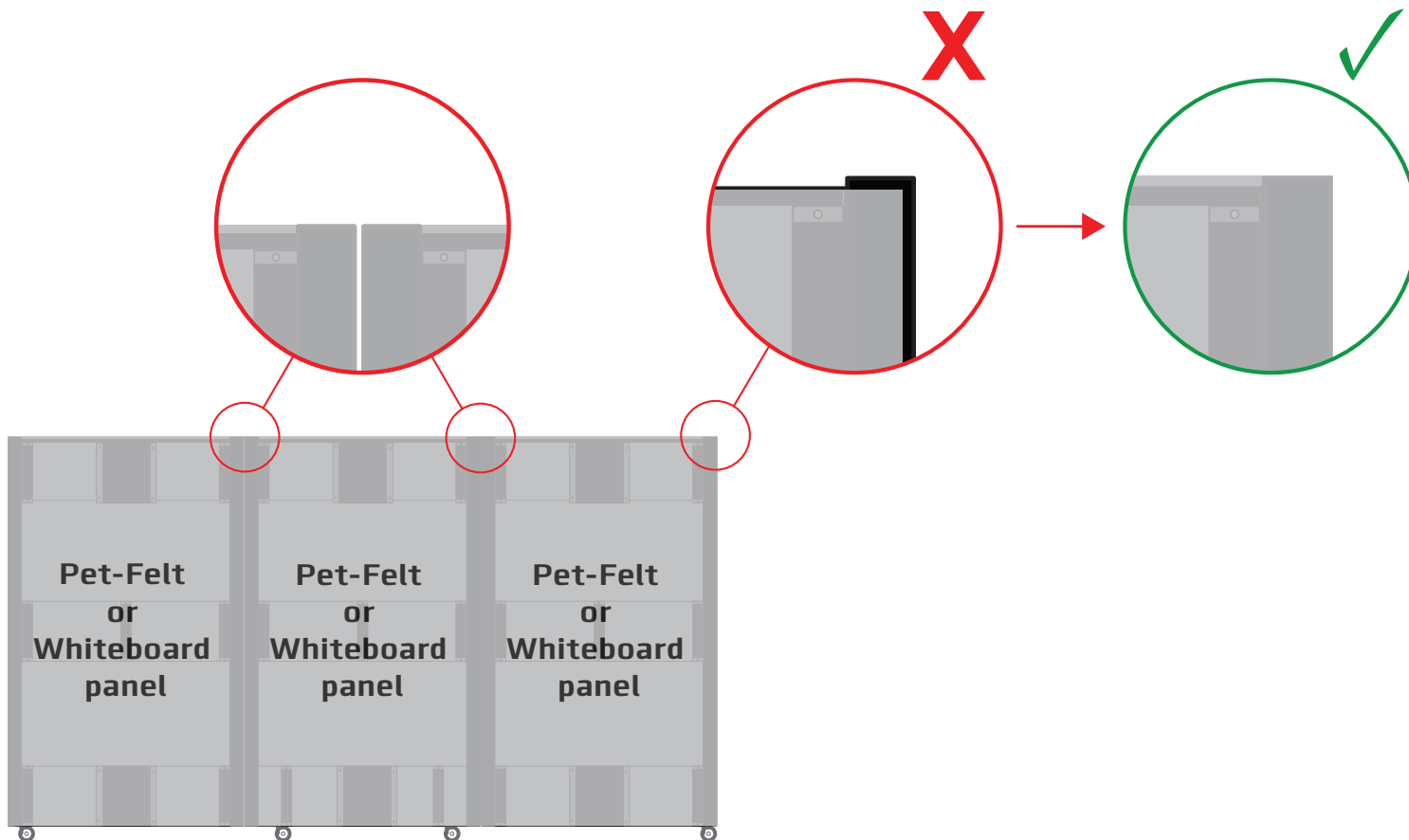
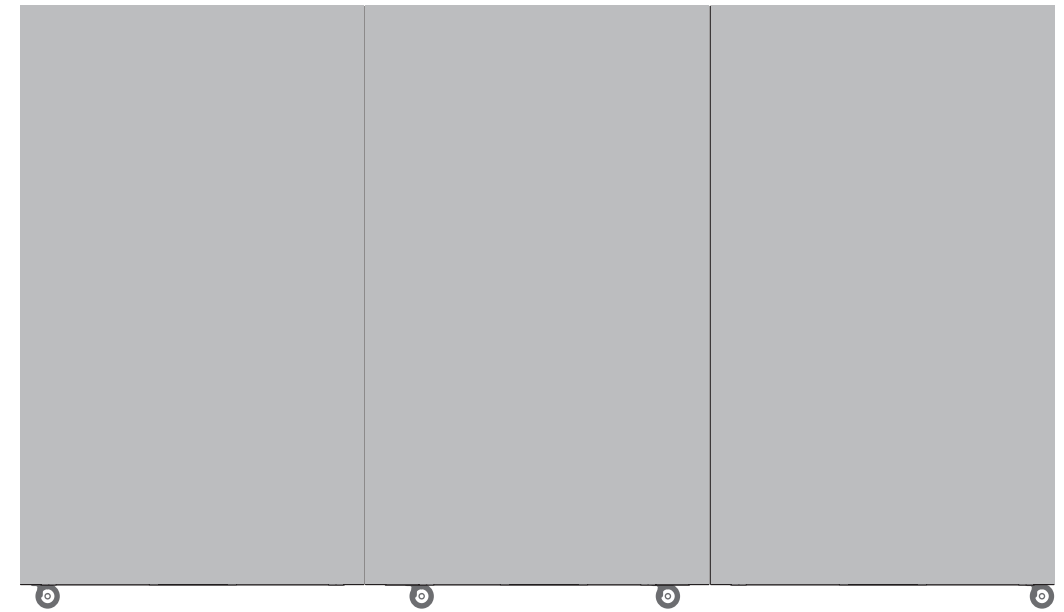
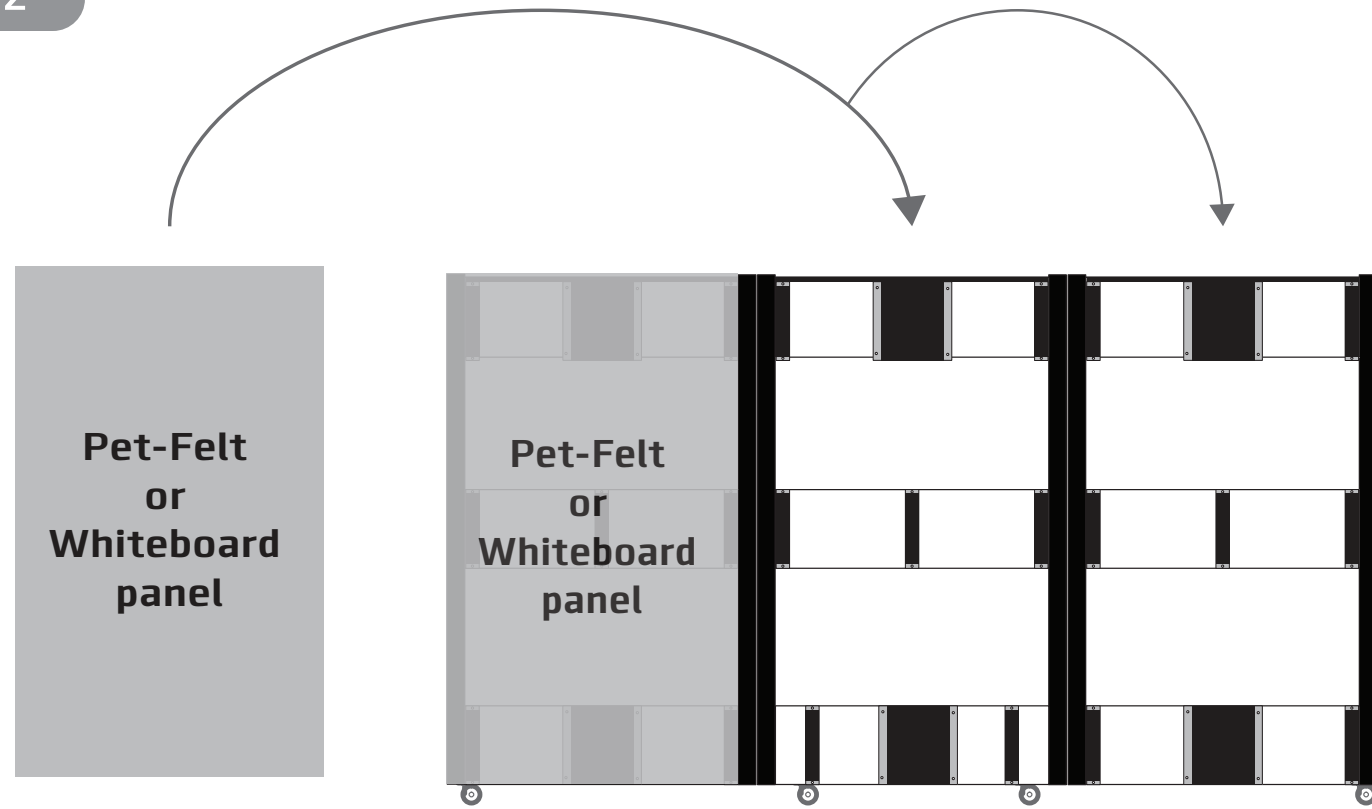

Instructions for wiping (printed) whiteboards

1. Clean the board after unpacking, and before using with whiteboard cleaning spray.
2. To prevent spreading the written ink, only wipe when it's completely dry. This is crucial with lacquered and printed boards because the solvents in the ink will cause damage to the board surface.
3. Only wipe dry ink with a clean (!) microfibre cleaning cloth or felt or paper wiper suitable for whiteboards.
4. Weekly clean the board with cleaning spray to maintain a good erasability.
5. Remove ghosting and stubborn marks with cleaning spray. Ink that has been on a whiteboard for weeks may be harder to remove.
6. NEVER use other cleaning agencies than real whiteboard cleaners for cleaning printed and coated steel boards. Aggressive cleaners like Glassex will cause permanent damage to the board surface.
7. When a wrong marker (flipchart marker, permanent marker) is used by accident: immediately clean the board with cleaning spray and a microfiber cloth. If that doesn't help, write over the written text with a whiteboard marker until it desolves. Clean the board with cleaning spray afterwards.
8. Only use alcohol-based markers are suited for whiteboards because they won't cause damage to the surface. Ketone-based markers are EXTREMELY harmful and can cause permanent damage to the surface.

Note! Some markers –even those of renowned brands- are poorly erasable.

Chameleon quality, for a lifetime

Smit Visual guarantees high quality products with a long lifespan. However, if you do find a defect in the product, please contact us immediately. We will then rapidly provide you with a suitable solution. If for some reason, you decide you no longer wish to use the product, remember that there may be people, foundations or voluntary organisations locally that could make use of the product. You can thus give your product a second life and extend its lifespan. If this is not the case, please dispose of the board according to official and/or statutory regulations for recycling. Depending on the type of board, our products contain wood, cardboard and metal parts. The environmentally friendly materials used in the board are therefore suitable for recycling. As an organisation, Smit Visual has a 100% CO₂ neutral policy. We take concrete action to minimise emissions. The remaining emissions are compensated through the globally recognised Trees for All certification. Thank you for your contribution to an environmentally friendly future.

